

D Series (Standard D-Sub)

90° Solder Dip (Male / Female)

Specifications

Insulation Resistance: 5,000MΩ min.
 Withstanding Voltage: 1,000 V AC
 Contact Resistance: 10mΩ max.
 Current Rating: 5A
 Operating Temp. Range: -55°C to +105°C

Materials and Finish

Insulator: Polyester Resin (glass filled) Fiber reinforced, UL94V-0
 Contacts: Stamped Copper Alloy
 Plating: Gold over Nickel

Features

- Special Au - Contact Plating available on Request
- M3 female threaded screw available on request

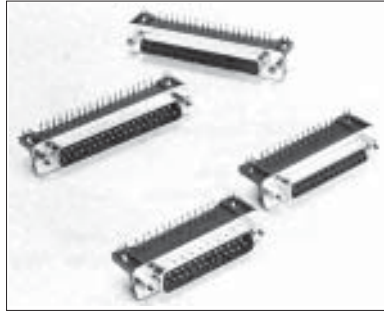

Part Number (Details)

D **R* - 25** ***** **1** *****

Series

Terminal Version:

RA = 7.2mm (US Std.)

RB = 9.4mm (Euro. Std.)

No. of Contacts

S = Female P = Male

PCB Assembly: 1 = With Snap-in

Connection Assembly Option:

1 = Fixed Female Screw Locks, 4-40

2 = Clinch Nut Rivetted, 4-40

(Without Female Screw Locks)

Outline Connector Dimensions (Male and Female)

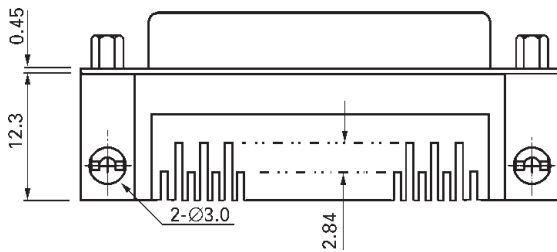
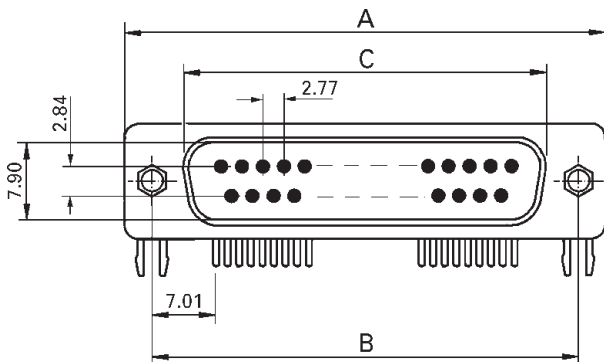

Recommended PCB Layout

Top View

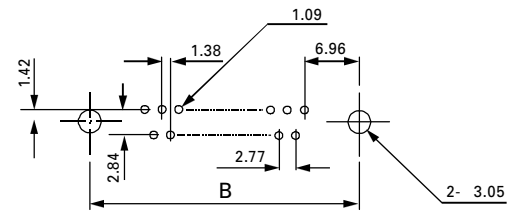

US- Standard:
(RA Terminal Version)

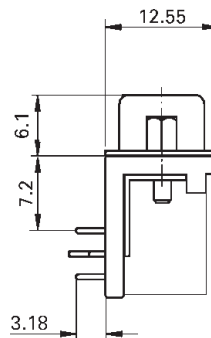

European- Standard:
(RB Terminal Version)

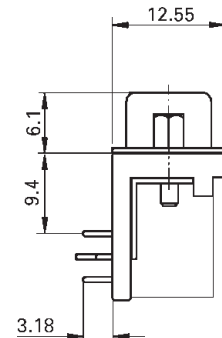

Part Number	No. of Contacts	A	B	C (Male)	C (Female)
DR*-09*1*	9	30.81	24.99	16.92	16.33
DR*-15*1*	15	39.14	33.32	25.25	24.66
DR*-25*1*	25	53.04	47.04	38.96	38.38
DR*-37*1*	37	69.32	63.50	55.42	54.84

This datasheet has been downloaded from:

www.DatasheetCatalog.com

Datasheets for electronic components.